

vtech[®]

Instruction Manual

Sort & Recycle Ride-On Truck[™]



INTRODUCTION

Thank you for purchasing the **Sort & Recycle Ride-On Truck™**. Take a ride and learn about recycling and the environment! Pick up blocks and sort them by shape and color, then store them inside the truck.

Mode Selector

12 Recycling Buttons

3 Smart Bins

3 Lights

Engine Button



Horn Button

Off/On/Volume Selector

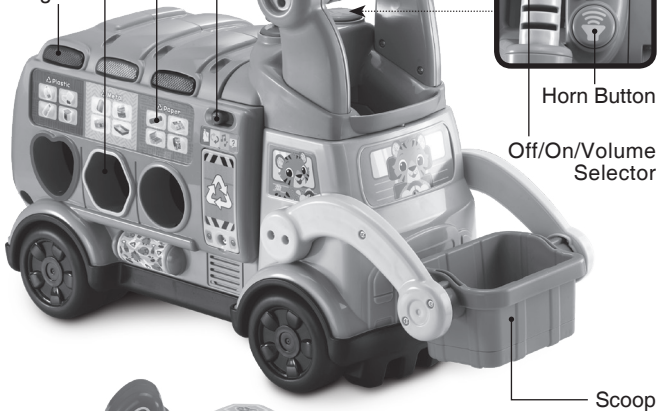

Scoop



6 Blocks

INCLUDED IN THE PACKAGE

- Sort & Recycle Ride-On Truck™
- 6 Blocks



- Label sheet

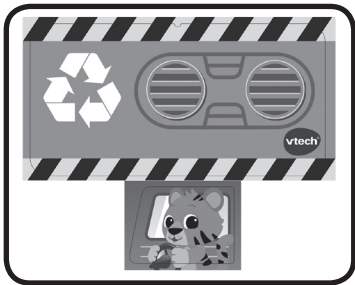

- Quick Start Guide

WARNING

All packing materials such as tape, plastic sheets, packaging locks, removable tags, cable ties, cords and packaging screws are not part of this toy, and should be discarded for your child's safety.

NOTE

Please save this Instruction Manual as it contains important information.

ATTENTION

Pour la sécurité de votre enfant, débarrassez-vous de tous les produits d'emballage tels que rubans adhésifs, feuilles de plastique, attaches, étiquettes, cordons et vis d'emballage. Ils ne font pas partie du jouet.

NOTE

Il est conseillé de sauvegarder ce manuel d'instructions car il comporte des informations importantes.

Unlock the Packaging Locks

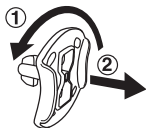

- ① Rotate the packaging locks counterclockwise 90 degrees.
- ② Pull out the packaging locks and discard.

WARNING!

The maximum weight for this product is 42 pounds. Insufficient strength. It is not recommended for children older than 36 months. If damaged do not use until repaired or replaced.

ATTENTION !

Résistance insuffisante. 20kg max. Ce jouet ne doit pas être utilisé par des enfants de plus de 36 mois. Si le jouet est endommagé, ne pas l'utiliser tant qu'il n'est pas ré paré ou remplacé.

GETTING STARTED

Battery Removal and Installation

1. Make sure the unit is turned **Off**.
2. Find the battery cover located under the Mode Selector. Use a screwdriver to loosen the screw, then open the battery cover.
3. Remove old batteries by pulling up on one end of each battery.
4. Install 2 new AA (AM-3/LR6) batteries following the diagram inside the battery box. (For best performance, alkaline batteries or fully charged Ni-MH rechargeable batteries are recommended.)
5. Replace the battery cover and tighten the screw to secure.

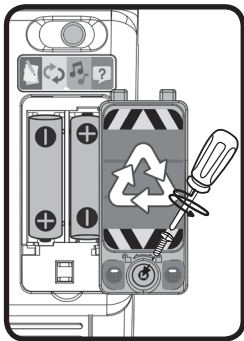

WARNING:

Adult assembly required for battery installation.
Keep batteries out of reach of children.

ATTENTION :

Les piles ou accumulateurs doivent être installés par un adulte.
Tenir les piles ou accumulateurs hors de portée des enfants.

IMPORTANT: BATTERY INFORMATION

- Insert batteries with the correct polarity (+ and -).
- Do not mix old and new batteries.
- Do not mix alkaline, standard (carbon-zinc) or rechargeable batteries.
- Only batteries of the same or equivalent type as recommended are to be used.
- Do not short-circuit the supply terminals.
- Remove batteries during long periods of non-use.
- Remove exhausted batteries from the toy.
- Dispose of batteries safely. Do not dispose of batteries in fire.

RECHARGEABLE BATTERIES

- Remove rechargeable batteries from the toy before charging.
- Rechargeable batteries are only to be charged under adult supervision.
- Do not charge non-rechargeable batteries.

LABEL APPLICATION

Please securely stick the labels to the toy as indicated below:

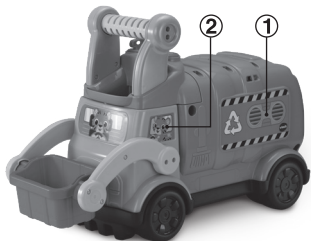
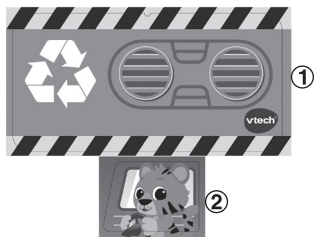

PRODUCT FEATURES

1. Scoop

Move the **Scoop** up and down to drop **Blocks** into the truck and play fun sound effects.

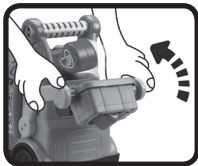
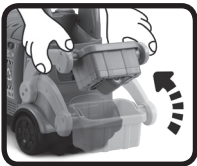

2. Engine Button

Press the **Engine Button** to hear engine sounds.



3. Horn Button

Press the **Horn Button** to hear horn sound effects.

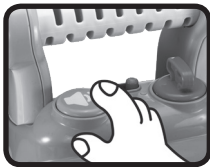

4. Recycling Buttons

Press the **Recycling Buttons** to learn how to help the environment and how to sort objects into bins for plastic, metal and paper.

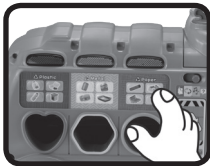

5. Mode Selector

Slide the **Mode Selector** to explore science concepts and more with Recycle, Reuse, Music and Quiz modes.

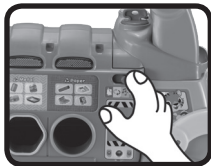

6. Off/On/Volume Selector

Slide the **Off/On/Volume Selector** to the volume position to adjust the Low or High volume. Slide the selector to the **Off** position to turn off the unit.

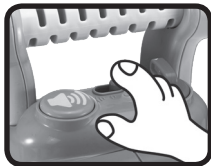

7. 3 Smart Bins

Insert a **Block** into a **Smart Bin** to learn about colors and shapes.

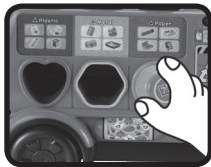

8. Storage

Scoop and sort the **Blocks** by shape and then store them in the truck.



9. Automatic Shut-Off

To preserve battery life, the **Sort & Recycle Ride-On Truck™** will automatically shut off after several minutes without input. The unit can be turned on again by sliding the **Mode Selector**.

The unit will also automatically turn off when the batteries are very low.

NOTE

If the unit powers down or if the lights fade during play, please install a new set of batteries.

ACTIVITIES

1. Recycle Mode

Press the **Recycling Buttons** to learn about objects by color and material. Put a **Block** into a **Smart Bin** to explore shapes.



2. Reuse Mode

Explore ways to reuse objects and learn about different materials. Press the **Recycling Buttons** or put a block into a **Smart Bin** to play.



3. Music Mode

Hear sung songs, melodies and sound effects by pressing the **Recycling Buttons**, inserting **Blocks** into the **Smart Bins**, moving the **Scoop** and pressing the **Engine** and **Horn Buttons**.



4. Quiz Mode ?

Show what you know! Identify objects and sort them correctly by color and material. Press the **Recycling Buttons** or insert a **Block** into a **Smart Bin** to answer. Correctly answer five questions in a row to hear a rewarding song and level up. There are three levels in all.



MELODIES

1. I'm Forever Blowing Bubbles
2. The Entertainer
3. The Wheels on the Bus
4. Looby Loo
5. Funiculi, Funicula
6. Mozart's Piano Sonata in C

SONG LYRICS

Song 1

Paper plastic metal goes
Paper plastic metal goes
Down the shoot and into the truck
Paper plastic metal goes.

Song 2

Three colored bins want to take your paper
Plastics and metals
Thank you, dear, for recycling
Three cheers for you!
Red for plastic and yellow for metal and blue for paper
Hooray, hooray, hooray, hooray
Keep up the great work!

Song 3

Take out the recyclables
Take out the recyclables
Take out the recyclables
To the proper bin, to the proper bin.

Song 4

It could be a bottle, box, or jug
Recycling plastic
Is like giving our planet a hug,
Is like giving our planet a hug.

Song 5

I pick up plastic, all kinds of plastic
The prettiest plastic that you ever did see
The green truck drives all around, all around
The green truck drives all around.

Song 6

Metal, metal, metal
Makes wonderful sounds
When it bounces around
It comes in all shapes
Some square, some round
Metal, metal, metal
Makes big, big sounds!

Song 7

Yellow bin, put metal in
Yellow bin, put metal in
Yellow bin, put metal in
It's recycling!

Song 8

Where does paper come from?
Wood helps make paper
Wood comes from trees
When trees are planted
They grow and grow and grow
Just like you do, too!

Song 9

Each morning, my grandma reads the newspaper
And then she goes to put it in a bin each afternoon
When I come to pick it up in my green truck
It's nicely stacked and sorted, what good luck!

CARE & MAINTENANCE

1. Keep the unit clean by wiping it with a slightly damp cloth.
2. Keep the unit out of direct sunlight and away from any direct heat sources.
3. Remove the batteries if the unit will not be in use for an extended period of time.
4. Do not drop the unit on hard surfaces and do not expose the unit to moisture or water.

TROUBLESHOOTING

If for some reason the unit stops working or malfunctions, please follow these steps:

1. Turn the unit **Off**.
2. Interrupt the power supply by removing the batteries.
3. Let the unit stand for a few minutes, then replace the batteries.
4. Turn the unit **On**. The unit should now be ready to use again.
5. If the unit still does not work, install a new set of batteries.

IMPORTANT NOTE:

If the problem persists, please call our **Consumer Services Department** at **1-800-521-2010** in the U.S. or **1-877-352-8697** in Canada, or by going to our website at **vtechkids.com** and filling out our **Contact Us** form located under the **Customer Support** link. Creating and developing **VTech®** products is accompanied by a responsibility that we take very seriously. We make every effort to ensure the accuracy of the information, which forms the value of our products. However, errors sometimes can occur. It is important for you to know that we stand behind our products and encourage you to contact us with any problems and/or suggestions that you might have. A service representative will be happy to help you.

NOTE

This equipment has been tested and found to comply with the limits for a Class B digital device, pursuant to Part 15 of the FCC Rules. These limits are designed to provide reasonable protection against harmful interference in a residential installation. This equipment generates, uses and can radiate radio frequency energy and, if not installed and used in accordance with the instructions, may cause harmful interference to radio communications. However, there is no guarantee that interference will not occur in a particular installation. If this equipment does cause harmful interference to radio or television reception, which can be determined by turning the equipment off and on, the user is encouraged to try to correct the interference by one or more of the following measures:

- Reorient or relocate the receiving antenna.
- Increase the separation between the equipment and receiver.
- Connect the equipment into an outlet on a circuit different from that to which the receiver is connected.
- Consult the dealer or an experienced radio/TV technician for help.

CAUTION

Changes or modifications not expressly approved by the party responsible for compliance could void the user's authority to operate the equipment.

Supplier's Declaration of Conformity 47 CFR § 2.1077 Compliance Information

Trade Name: VTech®
Model: 5418
Product Name: Sort & Recycle Ride-On Truck™
Responsible Party: VTech Electronics North America, L.L.C.
Address: 1156 W. Shure Drive, Suite 200,
Arlington Heights, IL 60004
Website: vtechkids.com

THIS DEVICE COMPLIES WITH PART 15 OF THE FCC RULES. OPERATION IS SUBJECT TO THE FOLLOWING TWO CONDITIONS: (1) THIS DEVICE MAY NOT CAUSE HARMFUL INTERFERENCE, AND (2) THIS DEVICE MUST ACCEPT ANY INTERFERENCE RECEIVED, INCLUDING INTERFERENCE THAT MAY CAUSE UNDESIRE OPERATION.

CAN ICES-003(B)/NMB-003(B)

**Visit our website for more
information about our products,
downloads, resources and more.**

vtechkids.com
vtechkids.ca

Read our complete warranty policy online at
vtechkids.com/warranty
vtechkids.ca/warranty



TM & © 2021 VTech Holdings Limited.
All rights reserved.
IM-541800-000
Version:0